

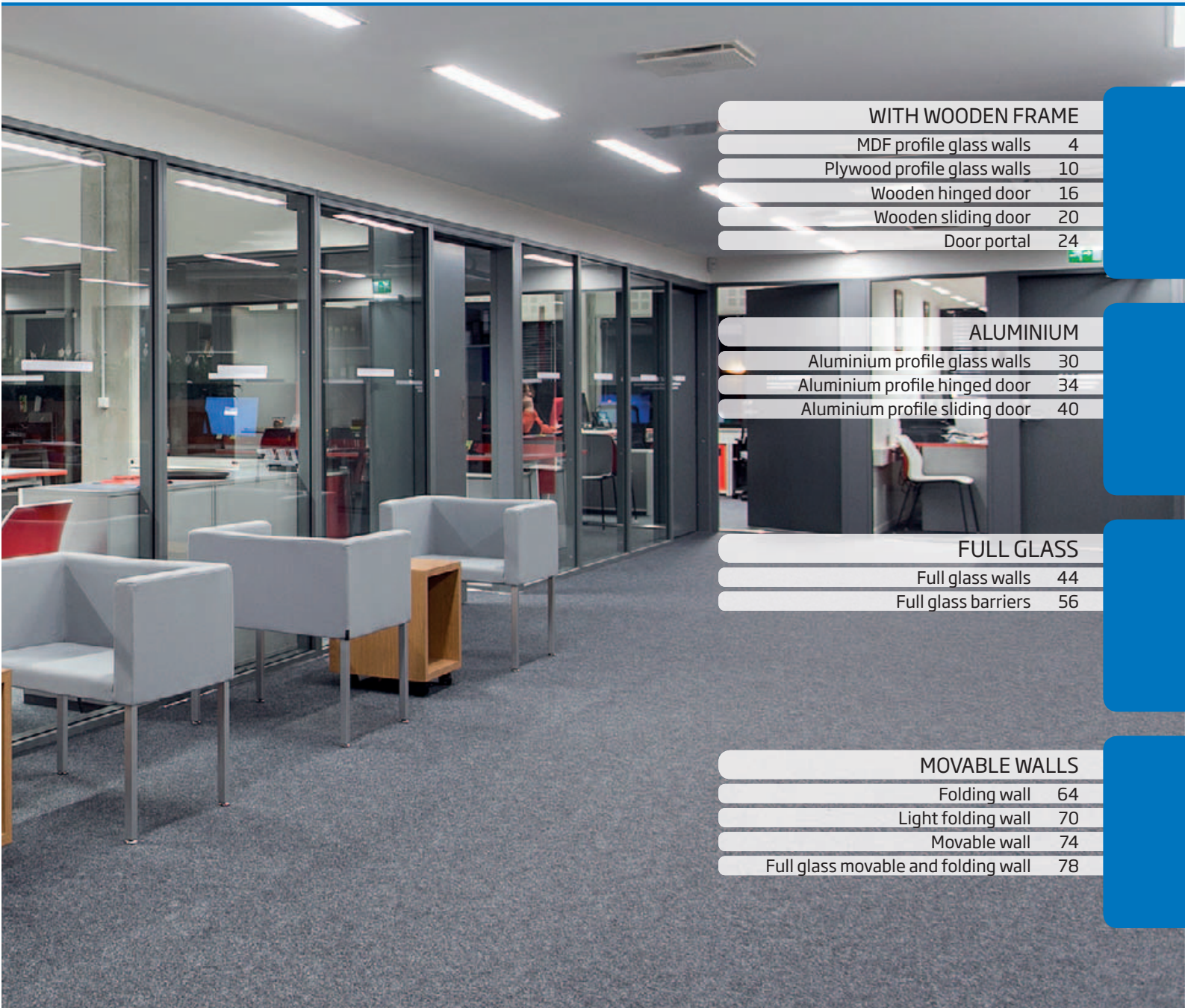

PRODUCT CATALOGUE





WITH WOODEN FRAME

MDF profile glass walls	4
Plywood profile glass walls	10
Wooden hinged door	16
Wooden sliding door	20
Door portal	24

ALUMINIUM

Aluminium profile glass walls	30
Aluminium profile hinged door	34
Aluminium profile sliding door	40

FULL GLASS

Full glass walls	44
Full glass barriers	56

MOVABLE WALLS

Folding wall	64
Light folding wall	70
Movable wall	74
Full glass movable and folding wall	78

MDF profile glass walls (MDF)

MDF profile glass walls are widely used in the design of office spaces. Unlimited possibilities for separation of spaces and fast installation make them one of the most popular products in the field of partition walls.

Depending on the choice, the finish of the profiles is paint, natural veneer or varnish. As the glass groove profile is based on the thickness of glass, there are no restrictions to the use of various glass types. It is also possible to use painted board, melamine, veneer or fabric panels in the module instead of glass. Actually, any decorative board can be used as filling material. As a standard solution, we manufacture modules with the same size, in order to simplify installation as well as re-design of the spaces in the future. MDF profile glass wall modules can be manufactured in accordance with the request of the customer also with special size, however, in this case maximum criteria of dimensions shall be specified in cooperation with the designer.

In addition to the profile with standard width, shelves can be integrated in wall systems, which make the look of the whole space more personal, while offering also practical and compact alternative to classical office furniture.

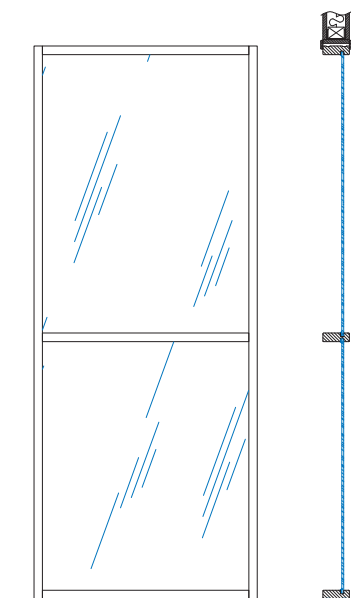

Dimensions of the profile (width × depth): 30 × 60mm (MDF60) / 30 × 92mm (MDF92) / 30 × 120mm (MDF120) / max 30 × 600 mm

Glass of standard solution: 6 mm / 44.2 / 55.2 / 66.2 laminated

Recommended width of a module: 250-1500 mm

Recommended height of a module: 2100-2800 mm

Sound resistance (Rw): 30-40 dB

Finish: painted according to paint catalogues (RAL/NCS), veneer, stain or varnish

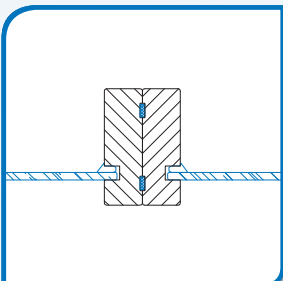

WITH WOODEN FRAME

ALUMINIUM

FULL GLASS

MOVABLE WALLS

MDF glass wall

Plywood glass
wall

Wooden hinged
door

Wooden sliding
door

Door portal





WITH WOODEN FRAME

ALUMINIUM

FULL GLASS

MOVABLE WALLS

MDF glass wall

Plywood glass
wall

Wooden hinged
door

Wooden sliding
door

Door portal





WITH WOODEN FRAME

ALUMINIUM

FULL GLASS

MOVABLE WALLS

MDF glass wall

Plywood glass
wallWooden hinged
doorWooden sliding
door

Door portal

Plywood profile glass walls (PW)

Plywood profile glass walls are mainly used for furnishing office spaces and separating workplaces. Uniqueness and natural beauty of birch plywood surface makes it an exclusive and highly demanded product in the places, where it is intended to highlight wood as a natural material. Unlimited possibilities for separation of spaces and fast installation make them one of the most popular products in the field of partition walls.

Finishing materials used for finishing the profile surface (stain, varnish or oil) highlight the beauty of birch plywood and extend the life and moisture resistance of plywood.

As the glass groove profile is based on the thickness of glass, there are no restrictions to the use of various glass types. It is also possible to use melamine, veneer or fabric panels in the module instead of glass. Actually, any decorative board can be used as filling material. As a standard solution, we manufacture modules with the same size, in order to simplify installation as well as re-design of the spaces in the future. Plywood profile glass wall modules can be manufactured in accordance with the request of the customer also with special size, however, in this case maximum criteria of dimensions shall be specified in cooperation with the designer.

In addition to the profile with standard width, shelves can be integrated in wall systems, which make the look of the whole space more personal, while offering also practical and compact alternative to classical office furniture.

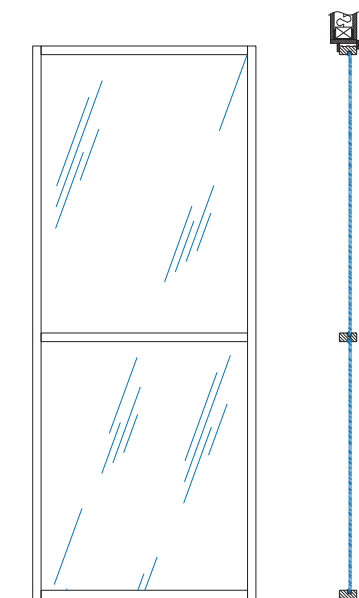

Dimensions of the profile (width × depth): 30 × 60mm (PW60) / 30 × 92mm (PW92) / 30 × 120mm (PW120) / max 30 × 600 mm

Recommended width of a module: 250-1500 mm

Recommended height of a module: 2100-2800 mm

Glass of standard solution: 6 mm / 44.2 / 55.2 / 66.2 laminated

Sound resistance (Rw): 30-40 dB

Finish: Stain and / or varnish

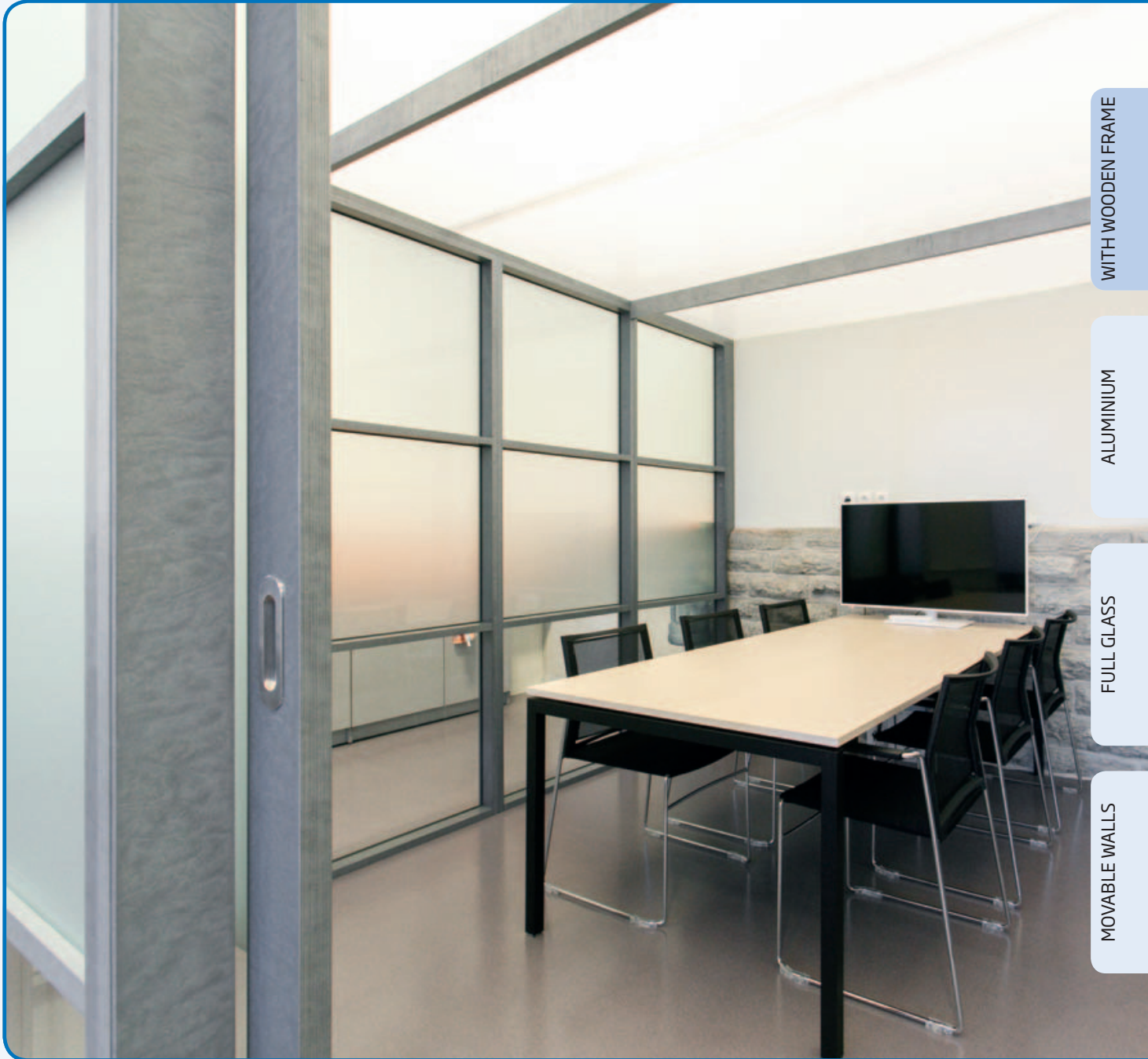

WITH WOODEN FRAME

ALUMINIUM

FULL GLASS

MOVABLE WALLS

MDF glass wall

Plywood glass wall

Wooden hinged door

Wooden sliding door

Door portal



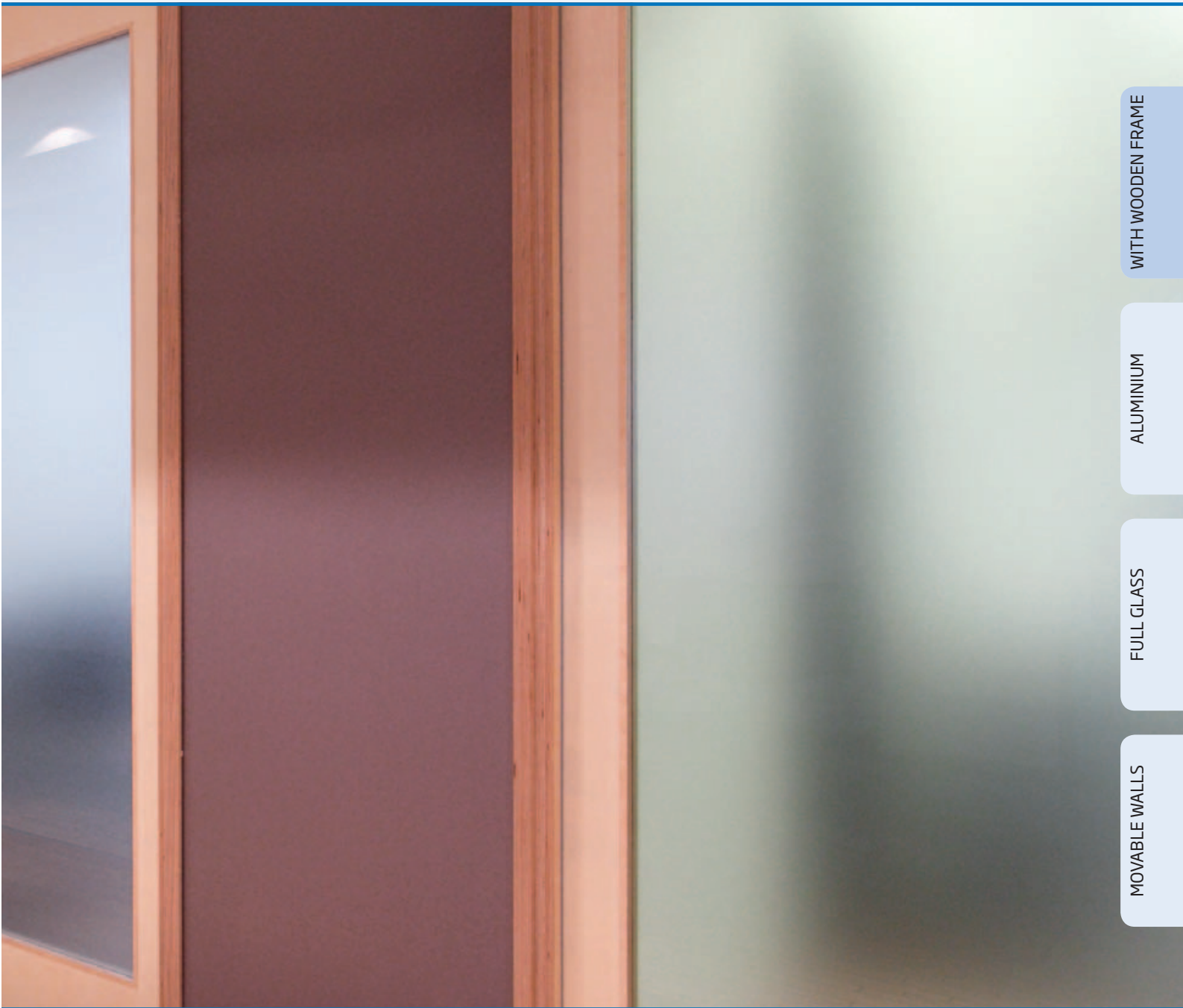

WITH WOODEN FRAME

ALUMINIUM

FULL GLASS

MOVABLE WALLS

MDF glass wall

Plywood glass wall

Wooden hinged door

Wooden sliding door

Door portal





WITH WOODEN FRAME

ALUMINIUM

FULL GLASS

MOVABLE WALLS

MDF glass wall

Plywood glass
wallWooden hinged
doorWooden sliding
door

Door portal

Wooden hinged door

Flat board door is the most common door type used for offices, office spaces, schools, hotels and other public spaces. Although paint is the main finishing solution, also natural and artificial veneer is common, which is also stained, varnished or oiled. Irrespective of the usage load of a door, we offer door sheets only with reinforced inserts.

We manufacture door sheets with flush as well as mantle edge, single-sided or double-sided, with or without glass aperture. Upon request, we make the depth of laminated timber frame based on the thickness of the wall, creating aesthetic finish between door and wall, without the need for additional slats for the door frame.

The offered furniture range is broad, but depends on the type and function of a door. Upon manufacture of regular doors, sound resistant doors, fire doors or heavy special doors it is important that the chosen furniture would meet the requirements set to the door. Properly chosen hinge, lock and handle provide final look to the doors and ensure long life.

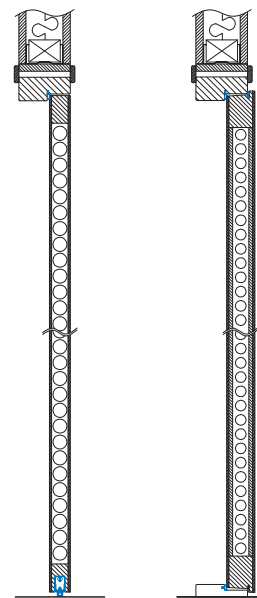

Dimensions of frame profile (width × depth):

42 × 92 and 42 × 120 mm

Standard width of a door:

600–2200 mm (from 1200 mm double-sided)

Standard height of a door:

2100–2400 mm

Thickness of door sheet:

40–62 mm

Glass of standard solution:

6 mm / 44.2 / 55.2 laminated

Sound resistance (R_w):

28–42 dB

Fire resistance:

– / EI30

Doorsill:

oak or descending seal

Lock:

ASSA, Abloy, Euro

Finish:

painted according to paint catalogues (RAL/NCS), veneer, stain, varnish, laminated



WITH WOODEN FRAME

ALUMINIUM

FULL GLASS

MOVABLE WALLS

MDF glass wall

Plywood glass
wall

Wooden hinged
door

Wooden sliding
door

Door portal





WITH WOODEN FRAME

ALUMINIUM

FULL GLASS

MOVABLE WALLS

MDF glass wall

Plywood glass
wallWooden hinged
doorWooden sliding
door

Door portal

Wooden sliding door

Wood profile sliding door with board or glass aperture is an alternative choice for smaller spaces, where a regular hinged door takes too much valuable space.

Sliding door with suspension or floor rail is a durable solution manufactured of MDF or plywood profile and finished with paint, veneer, stain or varnish. Glass used in standard product range is either 6 mm bright toughened glass or 44.2 plastic laminated security glass.

The mechanism of a sliding door with upper rail can be hidden or open, installed in the ceiling or in a wall, in separate opening or together with the system of glass partition walls. The only restriction is availability of free space with the width of the door sheet beside the existing doorway.

The main disadvantage of a sliding door compared to a hinged door is lack of sound resistance. Glassway has developed a sliding door type with sound resistance 34 dB and tested it successfully.

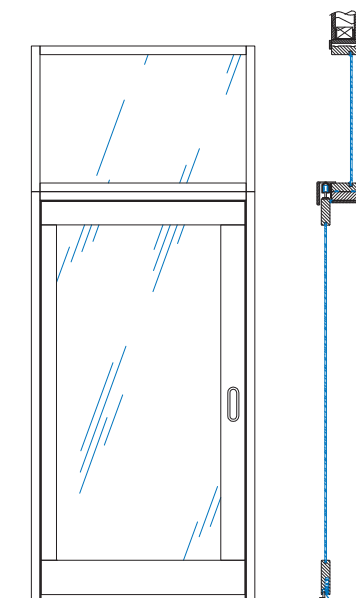

Dimensions of the profile (width × thickness): 92 × 30 and 120 × 30 mm (lower profile)

Recommended width of a sliding door: 700-1450 mm

Recommended height of a sliding door: 2100-2600 mm

Glass of standard solution: 6 mm / 44.2 laminated

Sound resistance (Rw): - / 34 dB

Lock: Assa, Abloy, Euro

Handle: flush or regular handle

Finish: painted according to paint catalogues (RAL/NCS), veneer, stain, varnish, laminated

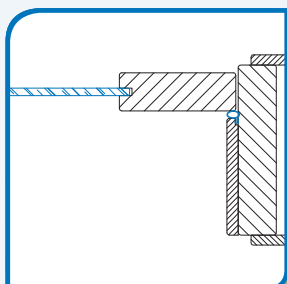

WITH WOODEN FRAME

ALUMINIUM

FULL GLASS

MOVABLE WALLS

MDF glass wall

Plywood glass
wall

Wooden hinged
door

Wooden sliding
door

Door portal





WITH WOODEN FRAME

ALUMINIUM

FULL GLASS

MOVABLE WALLS

MDF glass wall

Plywood glass
wallWooden hinged
doorWooden sliding
door

Door portal

Door portal (DP)

Door portal includes two main products: full glass wall and accompanying wooden door with a frame. It is a beautiful design element, highlighting the symbiosis of environment-friendly wood and ethereal glass. Door frame and fixing screws are usually hidden in the portal, resulting in the lack of visual lines between door frame and the portal and cover caps for hiding the screws. Paint, natural veneer or high pressure laminate is used for finishing the portal. Glassway door portal with ventilation holes has good sound resistance properties, ensuring also air circulation in the room without the need for additional ventilation system.

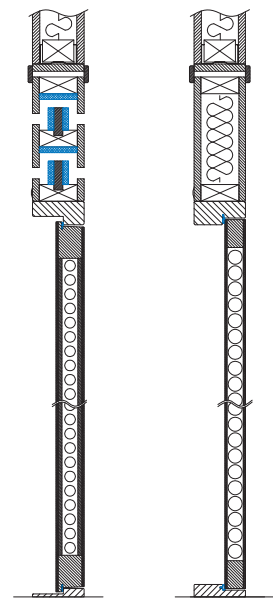

Recommended width of the portal: 1000-2000 mm

Recommended height of the portal: 2100-2800 mm

Thickness of the portal: 92-120 mm

Thickness of door sheet: 40-62 mm

Sound resistance (Rw): 28-40 dB

Portal with ventilation system: Rw 34 dB, air volume 18-80 l/s

Doorsill: oak or descending seal

Lock: ASSA, Abloy, Euro

Finish: painted according to paint catalogues (RAL/NCS), veneer, stain, varnish, laminated



WITH WOODEN FRAME

ALUMINIUM

FULL GLASS

MOVABLE WALLS

MDF glass wall

Plywood glass wall

Wooden hinged door

Wooden sliding door

Door portal

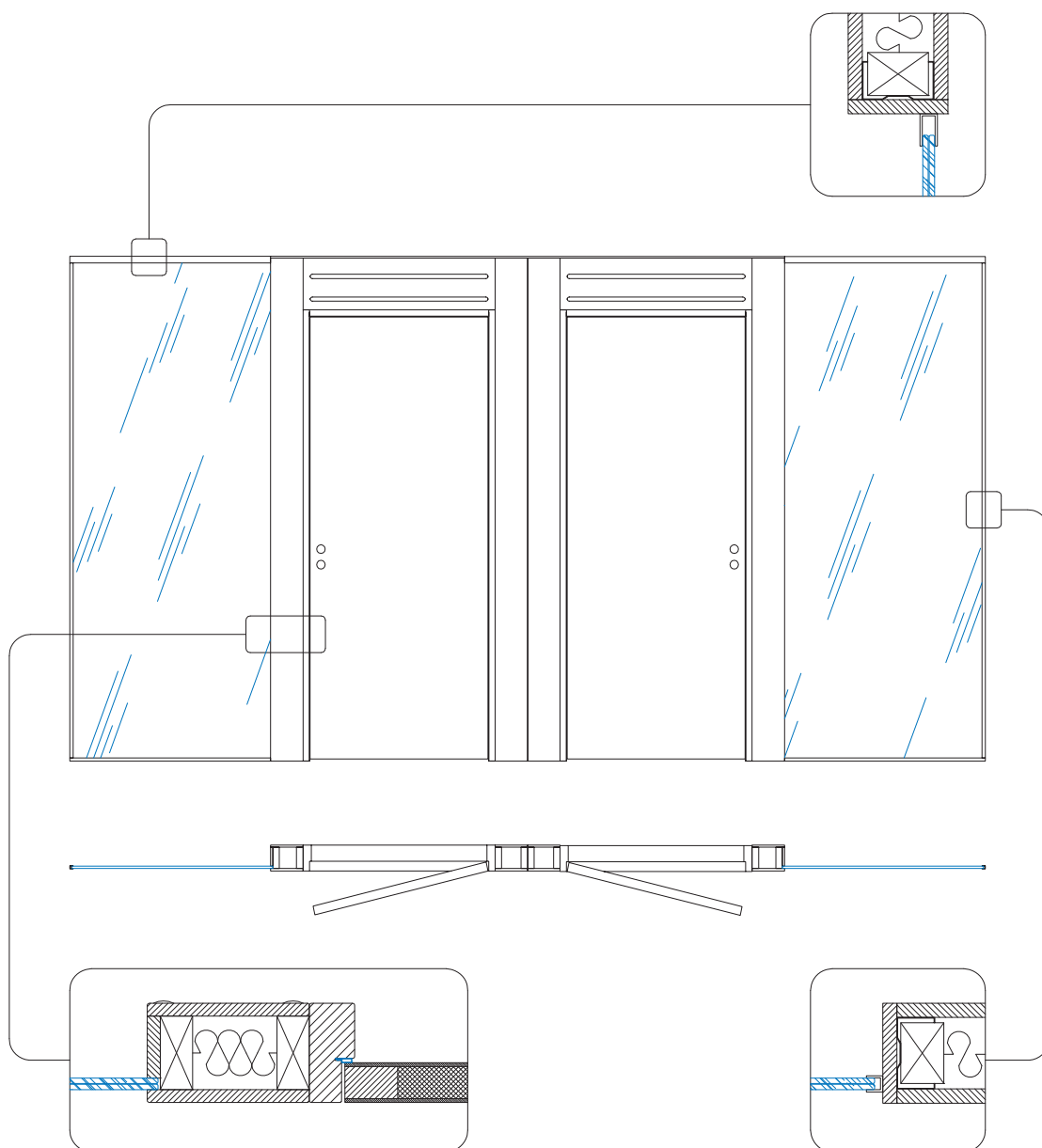



WITH WOODEN FRAME

ALUMINIUM

FULL GLASS

MOVABLE WALLS

MDF glass wall

Plywood glass
wall

Wooden hinged
door

Wooden sliding
door

Door portal



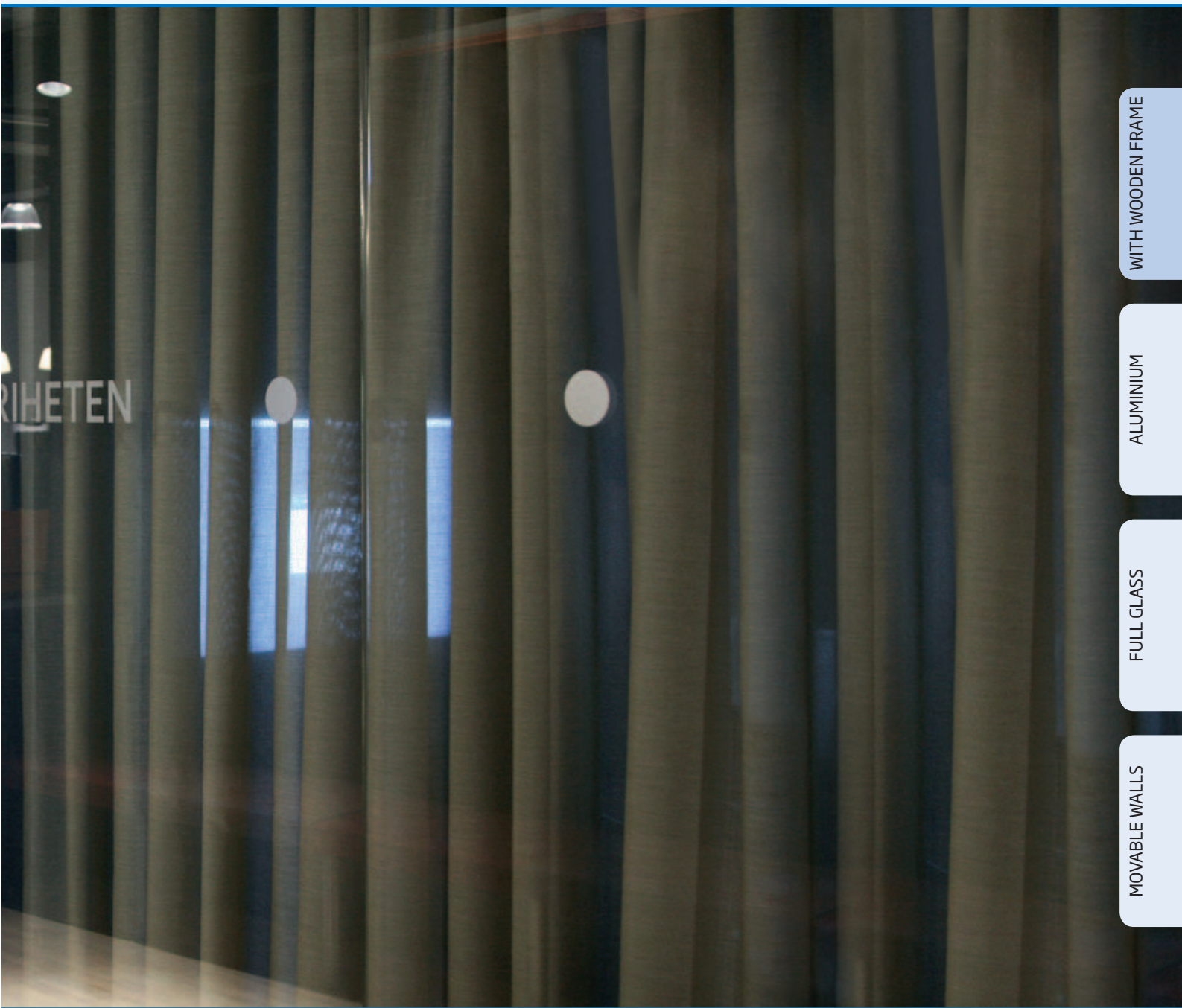

WITH WOODEN FRAME

ALUMINIUM

FULL GLASS

MOVABLE WALLS

Aluminium profile glass walls (AL50)

Aluminium profile glass walls are widely used in the design of office spaces. Unlike other profile materials, aluminium has better moisture resistance and lighter weight, also smaller dimensions, and has visually more slender effect. By adding a vertical stiffening profile between the modules, the recommended structural stiffness is ensured also at the wall height 3000 mm.

Aluminium profile partition walls are ideally suitable for the spaces with high moisture level (spas, saunas, cold stores, production buildings, warehouse spaces etc), but also for the spaces, where straight and smooth surfaces are intended as design elements. Unlike full glass solution, an aluminium profile product is more rigid, stable and better to move.

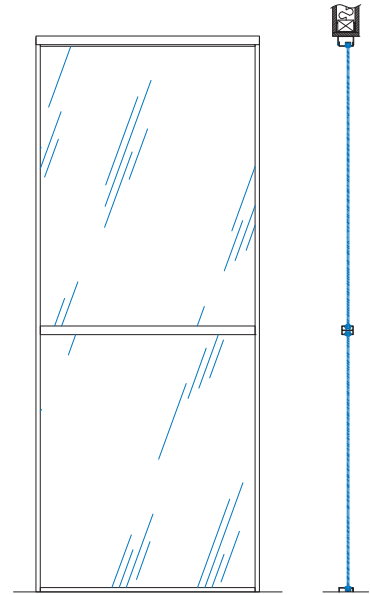

Dimensions of the profile (width × depth): 15 × 50 mm

Recommended width of a module: 250–1500 mm

Recommended height of a module: 2100–3000 mm

Glass of standard solution: 6 mm / 44.2 / 55.2 laminated

Sound resistance (Rw): – / 35 dB

Finish: powder paint according to RAL paint catalogue or naturally anodised

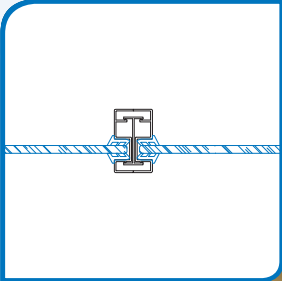

WITH WOODEN FRAME

ALUMINIUM

FULL GLASS

MOVABLE WALLS

Aluminium glass wall

Aluminium hinged door

Aluminium sliding door





WITH WOODEN FRAME

ALUMINIUM

FULL GLASS

MOVABLE WALLS

Aluminium profile hinged door

Glassway product range includes two different types of hinged door: with flush edge and mantle edge. Hinged door with flush edge and small dimensions is intended mainly for use in Glassway aluminium profile partition walls, being as modest as possible and ensuring the recommended sound resistance for the entire partition wall system. Aluminium door with mantle edge is a suitable also as a separate aperture filling solution, providing higher security than a wooden door, while being lighter and visually more pleasant than a steel profile door. In addition to two typical solutions, the product range includes combined aluminium profile interior doors, where aluminium frame is used, but door sheet is filled with full glass or wooden door sheet, which can be painted, stained or laminated. Full glass door sheet with aluminium frame is a product used commonly in spas as steam sauna doors, while it is also an ideal choice for full glass walls, where sound resistance is required.

Veneer door sheet with aluminium frame is a suitable choice for the rooms, where the intention is to highlight the warmth and uniqueness of natural wooden material in aluminium profile partition walls with clear straight lines.

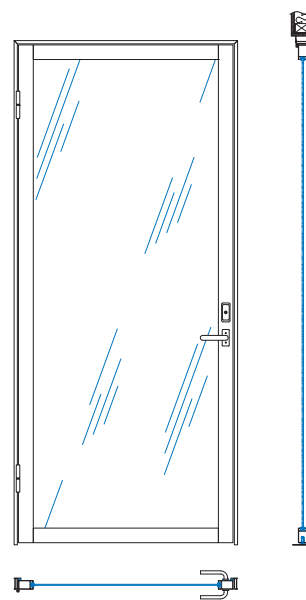

Dimensions of the profile (width × depth):	15 × 50 and 30 × 50 mm
Recommended width of a door:	600–2000 mm (from 1200 mm double-sided)
Recommended height of a door:	2100–2400 mm
Thickness of door sheet:	40 mm (aluminium or wooden door sheet), 8–10 mm (full glass door sheet)
Glass of standard solution:	6–8 mm / 44.2 / 55.2 laminated
Sound resistance (R _w):	30–35 dB
Doorsill:	aluminium or descending seal
Lock:	ASSA, Abloy, Euro
Finish:	powder paint according to RAL paint catalogue or naturally anodised
Wooden door sheet-	painted according to paint catalogues (RAL/NCS), veneer, stain, varnish, laminated

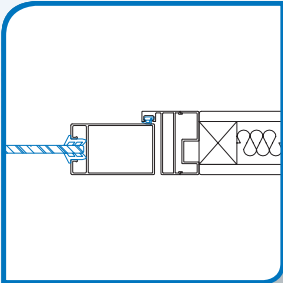

WITH WOODEN FRAME

ALUMINIUM

FULL GLASS

MOVABLE WALLS

Aluminium glass wall

Aluminium hinged door

Aluminium sliding door

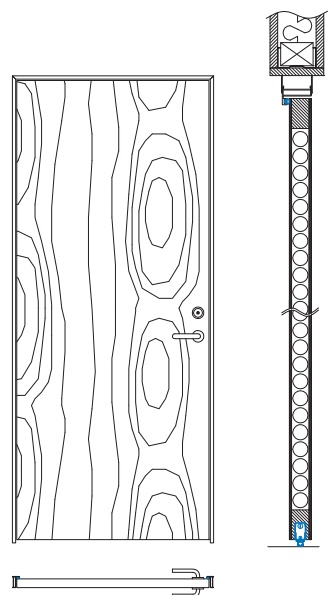
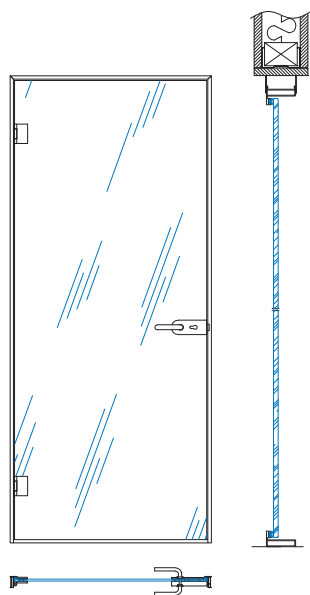
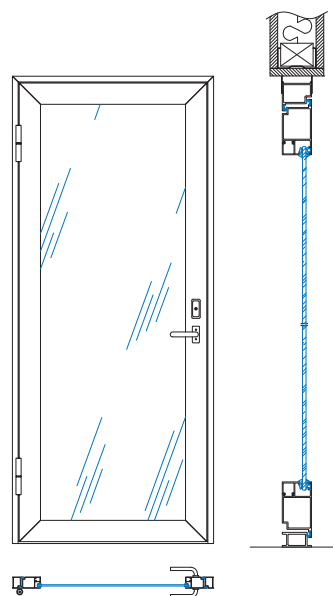
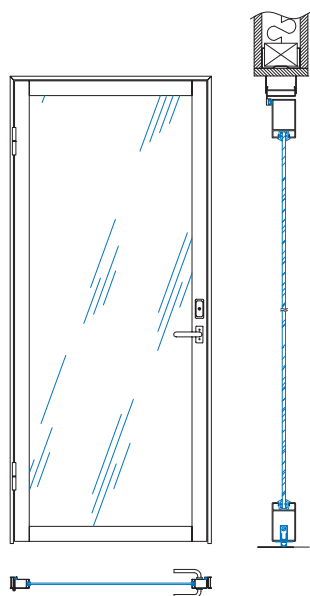



WITH WOODEN FRAME

ALUMINIUM

FULL GLASS

MOVABLE WALLS

Aluminium glass wall

Aluminium hinged door

Aluminium sliding door





WITH WOODEN FRAME

ALUMINIUM

FULL GLASS

MOVABLE WALLS

Aluminium profile sliding door

Sliding door is an alternative choice for smaller spaces, where a regular hinged door takes too much valuable space.

Aluminium profile sliding door with suspension or floor rail is a durable and weatherproof solution manufactured of natural anodised profile or powder painted according to RAL paint catalogue.

Glass used in standard product range is either 6 mm bright toughened glass or 44.2 plastic laminated security glass.

The mechanism of a sliding door with upper rail can be hidden or open, installed in the ceiling or in a wall, in separate opening or together with the system of glass partition walls. The only restriction is availability of free space with the width of the door sheet beside the existing doorway.

The main disadvantage of a sliding door compared to a hinged door is lack of sound resistance. Glassway has developed a sliding door type with sound resistance 34 dB and tested it successfully.

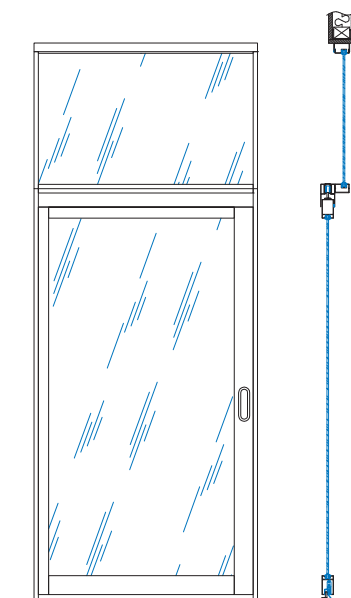

Dimensions of the profile (width × thickness): 66 × 40 mm

Recommended width of a sliding door: 700–1450 mm

Recommended height of a sliding door: 2100–2600 mm

Glass of standard solution: 6 mm / 44.2 laminated

Sound resistance (Rw): 34 dB

Lock: Abloy, Assa, Euro

Handle: flush, or regular handle

Finish: powder paint according to RAL paint catalogue or naturally anodised

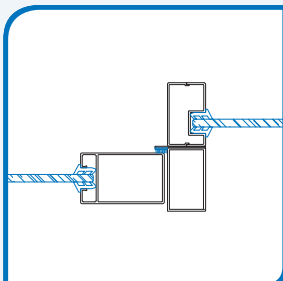

WITH WOODEN FRAME

ALUMINIUM

FULL GLASS

MOVABLE WALLS

Aluminium glass wall

Aluminium hinged door

Aluminium sliding door





WITH WOODEN FRAME

ALUMINIUM

FULL GLASS

MOVABLE WALLS

Full glass walls (TK)

Timeless minimalism is a keyword characterising glass best. Full glass walls and doors create spaciousness and elegance in spaces. Their field of use is broad, from large retail centres to shower rooms at home. The solution used most extensively in offices and public spaces creates spaciousness upon separation of spaces, while also creating privacy with good sound insulation (up to 40 dB). Lack of vertical profiles makes this solution stylish and beautiful. The range of horizontal aluminium profiles for full glass walls is broad, from completely flush U-profiles to high plinth profiles. Any plastic film can be added to glass, in order to make the room more personal or to create more privacy.

Finish of the profiles is natural anodising, powder paint or stainless steel. Various special solutions are also possible in case of full glass walls – even curved walls!

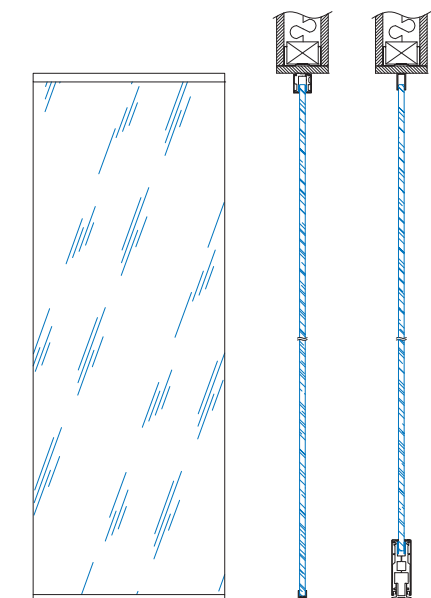

Dimensions of standard profiles
(height × width):

U 15 × 15 / 16 × 30 mm;
clamp 40 × 30 / 100 × 35 mm

Glass of standard solution:

8-12 mm / 55.2 / 66.2 laminated

Recommended wall height:

55.2 glass max H = 2400 mm / 10 mm glass max H = 3000 mm / 66.2 glass max H = 3200 mm /
12 mm glass max H = 3600 mm

Finish of profiles:

powder paint according to RAL paint catalogue or naturally anodised

Sound resistance (Rw):

34-40 dB

Full glass doors:

hinged or sliding door

Lock:

systems Roca, Dorma, Geze

Glass edges are phase polished, joints between glass panels (2-3 mm) are open or filled with colourless silicone or glass tape.

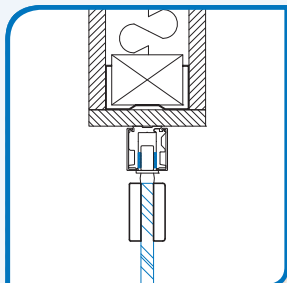

WITH WOODEN FRAME

ALUMINIUM

FULL GLASS

MOVABLE WALLS

Full glass walls

Glass barriers





WITH WOODEN FRAME

ALUMINIUM

FULL GLASS

MOVABLE WALLS

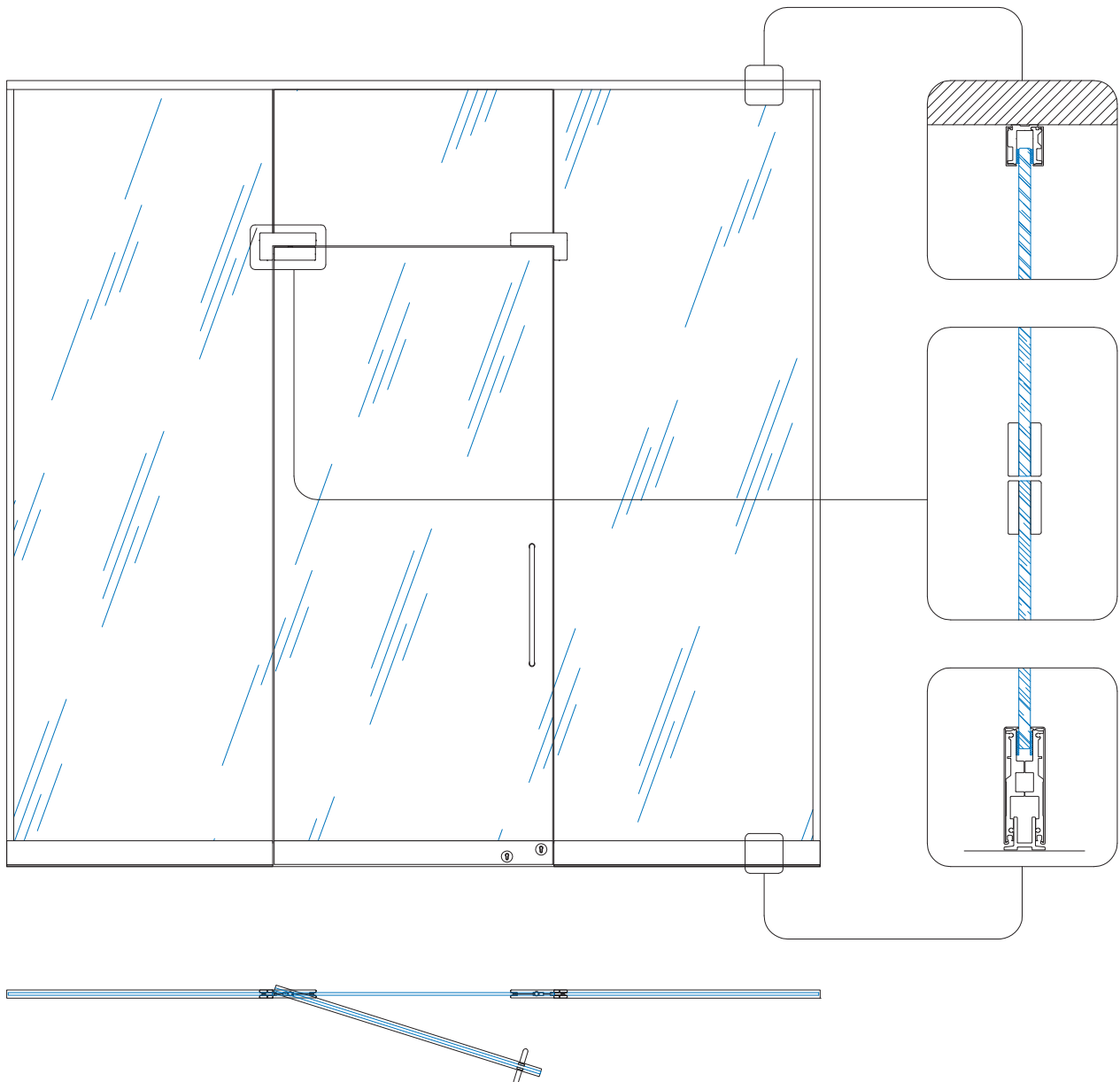



WITH WOODEN FRAME

ALUMINIUM

FULL GLASS

MOVABLE WALLS

Full glass walls

Glass barriers





WITH WOODEN FRAME

ALUMINIUM

FULL GLASS

MOVABLE WALLS

Full glass walls

Glass barriers





WITH WOODEN FRAME

ALUMINIUM

FULL GLASS

MOVABLE WALLS

Full glass walls

Glass barriers





WITH WOODEN FRAME

ALUMINIUM

FULL GLASS

MOVABLE WALLS

Glass barriers

Glass barrier is a modern and stylish alternative to wooden and steel barriers. By diminishing the sense of limitation, glass barrier brings plenty of spaciousness, air and light into the room. A barrier made of laminated and toughened security glass is rigid, stable and resistant to weather as well as mechanical impact. Using stainless steel furniture or aluminium profile fixing solutions, it is a suitable solution both indoors and outdoors.

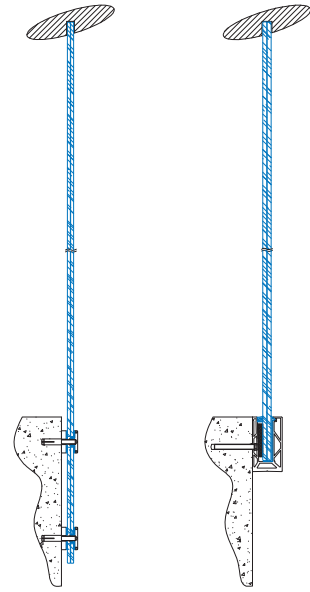

Fixing: aluminium profile, stainless steel point fixings or steel pillars

Glass of standard solution: 66.2 / 88.2 / 1010.2 laminated

Handrail: stainless steel, aluminium profile or wooden profile

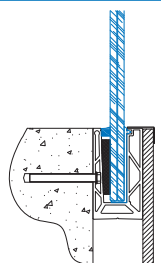

WITH WOODEN FRAME

ALUMINIUM

FULL GLASS

MOVABLE WALLS

Full glass walls

Glass barriers





WITH WOODEN FRAME

ALUMINIUM

FULL GLASS

MOVABLE WALLS

Full glass walls

Glass barriers





WITH WOODEN FRAME

ALUMINIUM

FULL GLASS

MOVABLE WALLS

Full glass walls

Glass barriers





WITH WOODEN FRAME

ALUMINIUM

FULL GLASS

MOVABLE WALLS

Folding wall (VOL1)

Folding wall is a suitable solution in larger spaces, where the space separation speed and good sound insulation are essential criteria.

Folding wall includes panels mutually joined with aluminium hinges, which are moving on a rail fixed to the ceiling so that wall panels can be parked to one or both ends of the rails upon opening. The last panel of a folding wall can be used as passage door. Panels are latched to the floor in closed position. Such types of folding wall panels are made of aluminium profiles filled with sound insulation materials with various properties, particle board and rubber seals, in order to ensure good sound resistance of the wall structure.

It is possible to add windows to decorative closed panels, which help to bring natural light into the rooms.

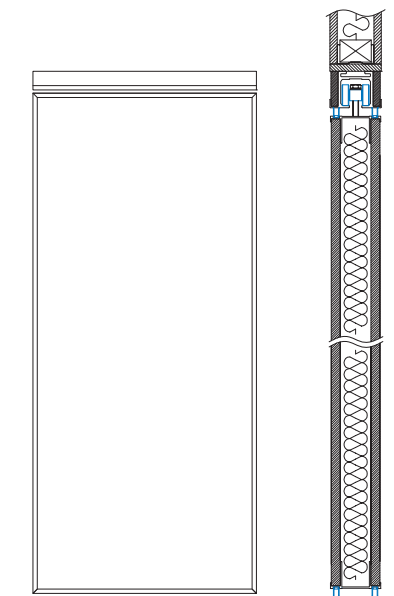

Wall thickness: 90 mm

Recommended width of a panel: 400-1100 mm (standard 900 mm)

Recommended height of a panel: up to 4000 mm

Wall weight: 26-48 kg/m², depending on sound insulation

Sound resistance (R_w): 38-50 dB

Finish: standard white, painted or wood imitation melamine, natural veneer, laminated, special solutions (school blackboard, magnetic board, cork etc)

Profiles: aluminium, powder painted according to RAL paint catalogue or naturally anodised

Lock: Assa, Abloy, Euro

Handle: flush handle

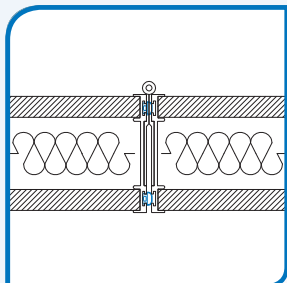

WITH WOODEN FRAME

ALUMINIUM

FULL GLASS

MOVABLE WALLS

Folding wall

Light folding wall

Movable wall

Full glass movable
and folding wall

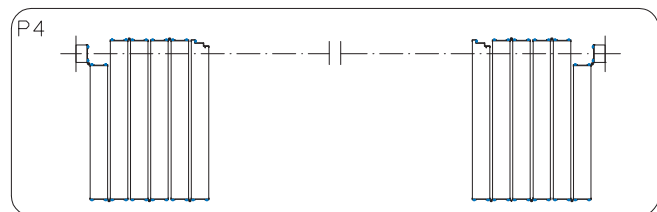
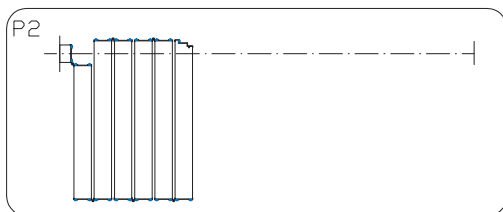
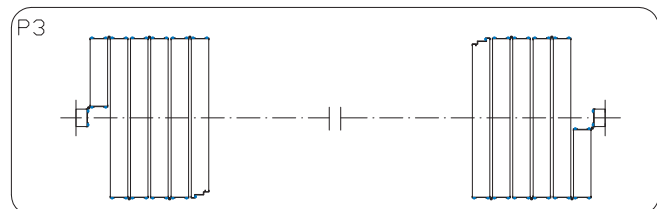
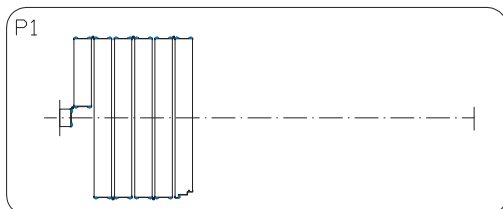
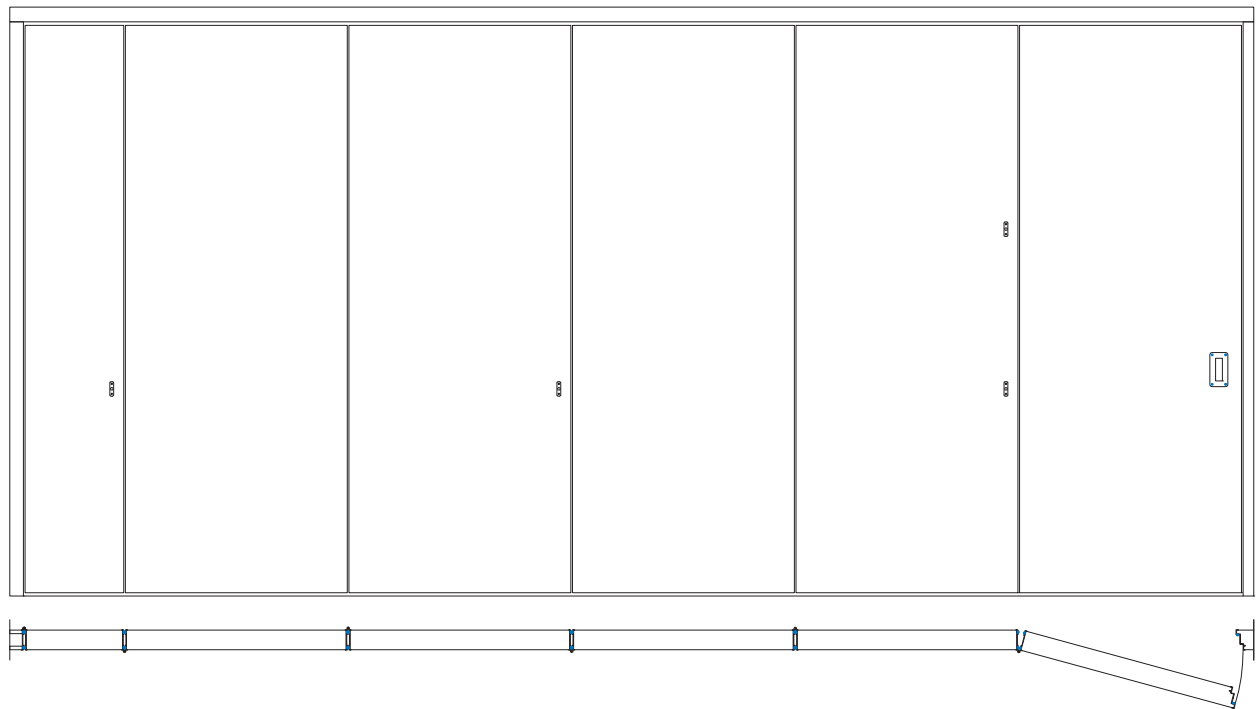



WITH WOODEN FRAME

ALUMINIUM

FULL GLASS

MOVABLE WALLS

Folding wall

Light folding wall

Movable wall

Full glass movable
and folding wall





WITH WOODEN FRAME

ALUMINIUM

FULL GLASS

MOVABLE WALLS

Folding wall

Light folding wall

Movable wall

Full glass movable
and folding wall

Light folding wall (VOL2)

Light folding wall is an excellent solution for fast separation of parts of large spaces, such as offices, schools and nursery schools, in order to improve functionality of the space. Light folding wall is also ideally suitable for a home. Compact and light folding wall includes panels mutually joined with hinges, which are moving silently and smoothly on a rail fixed to the ceiling. Wall panels can be parked to one or both ends of the rails upon opening. Such types of folding wall panels are made of pressed panels with light filling material. If necessary, it is possible to add windows and seals in a panel, while it is also possible to achieve sound insulation up to 34 dB. As a standard solution, folding wall is manufactured with flush hidden hinges inside the panel, leaving the impression of a uniform flat wall in closed position.

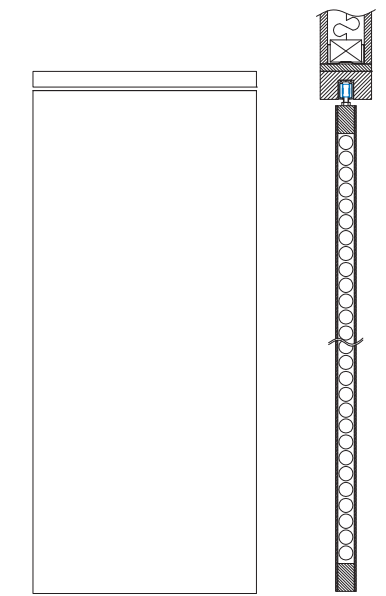

Thickness of a panel: 40 mm

Recommended width of a panel: 200-600 mm (standard 450 mm)

Recommended height of a panel: up to 3000 mm

Wall weight: 16 kg/m²

Sound resistance (R_w): - / 34 dB

Finish: painted MDF, natural veneer, laminated, special solutions (school blackboard, white magnetic board etc)

Lock: Assa, Abloy, AGB hook lock

Handle: regular handle (Abloy, Diamantek etc)

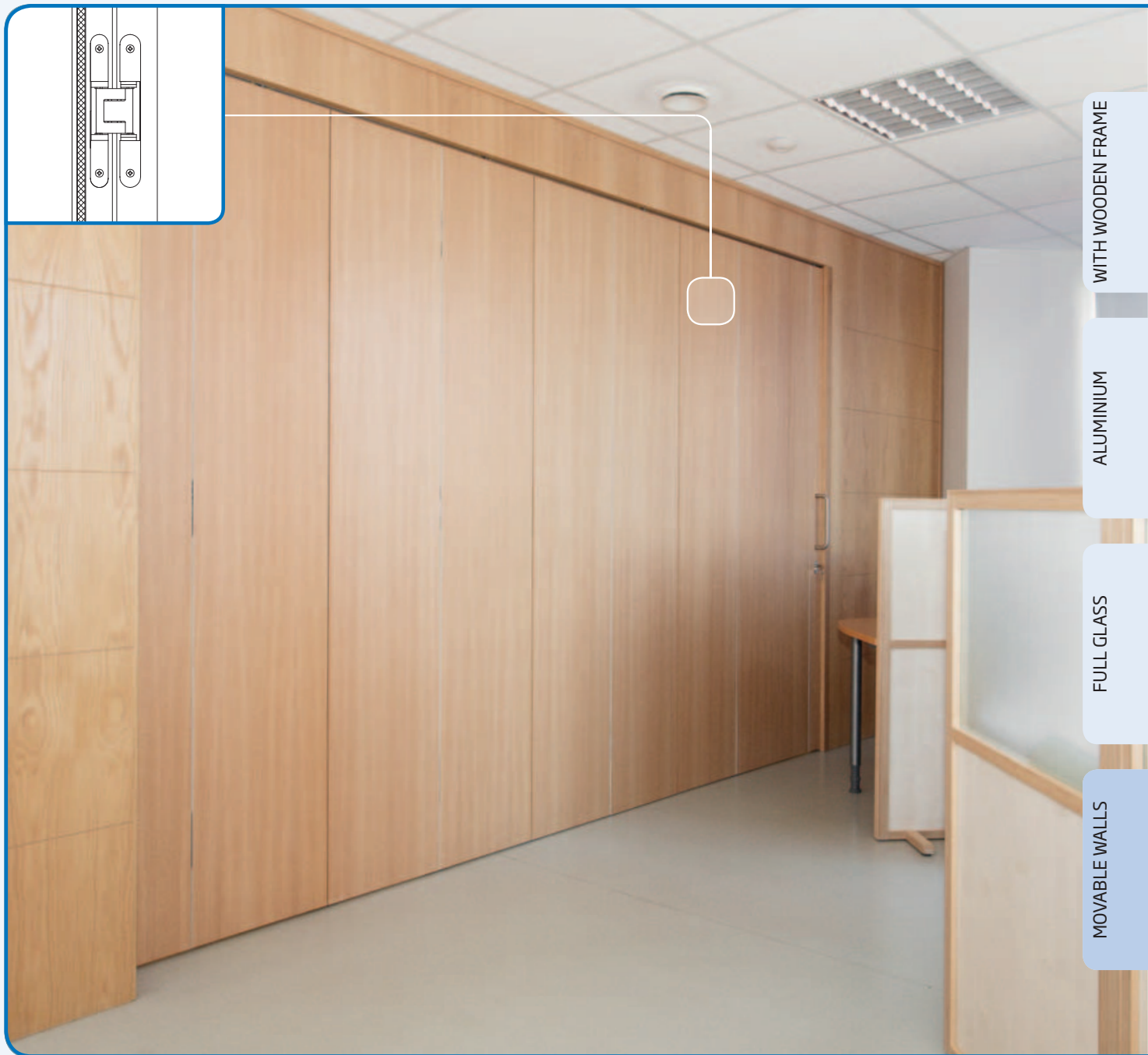
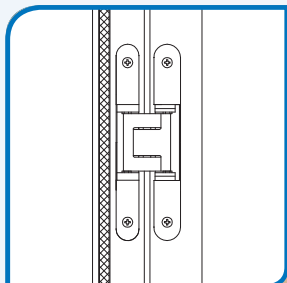

WITH WOODEN FRAME

ALUMINIUM

FULL GLASS

MOVABLE WALLS

Folding wall

Light folding wall

Movable wall

Full glass movable
and folding wall

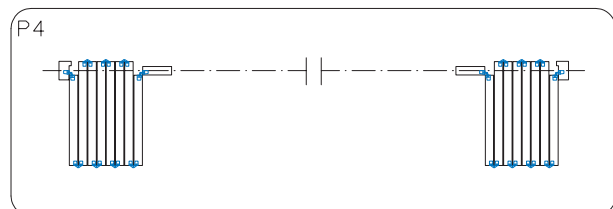
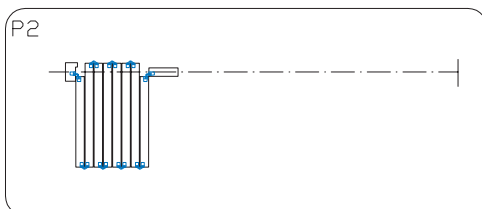
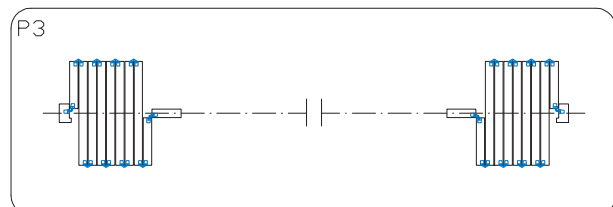
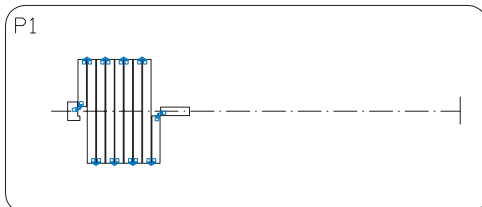
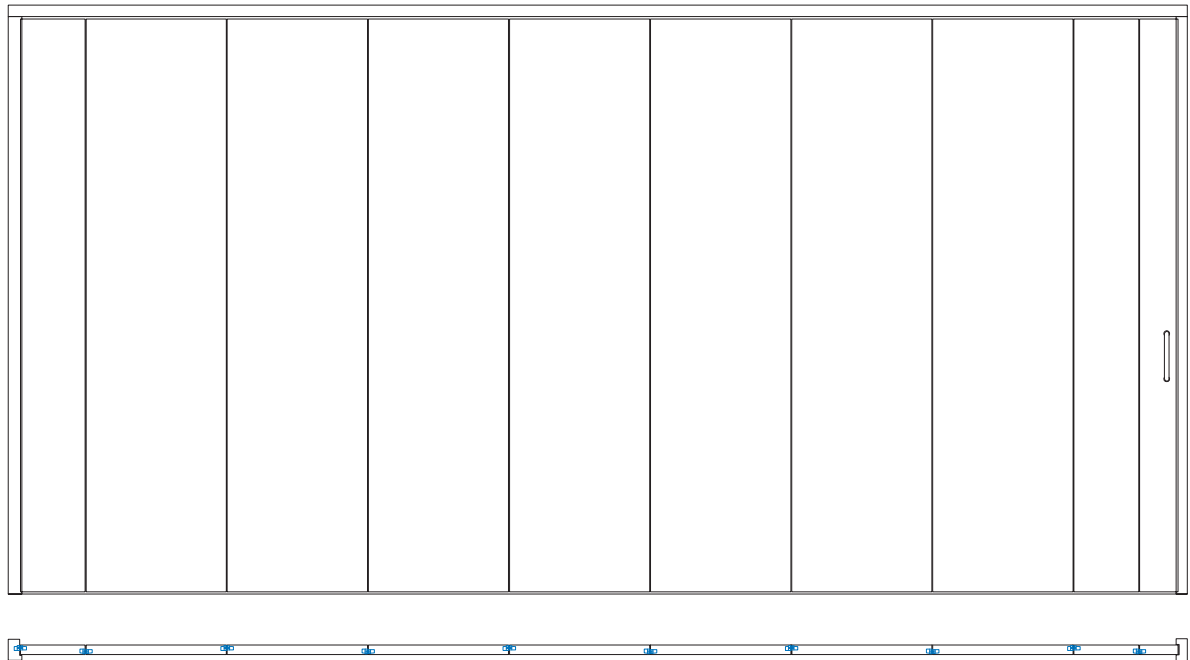



WITH WOODEN FRAME

ALUMINIUM

FULL GLASS

MOVABLE WALLS

Folding wall

Light folding wall

Movable wall

Full glass movable
and folding wall

Movable wall (SW)

Flexible and efficient use of space is the basic criterion for designing and furnishing of offices, hotels, conference and exhibition centres. Glassway movable wall is created mainly for fast separation of spaces with open plan. It is suitable also for high spaces.

High sound insulation (up to 55 dB) is suitable also for a demanding customer. It is possible to add windows to decorative closed panels, which help to bring natural light into the rooms. Unlike folding walls, the panels of movable walls can be parked away from the aperture, where the wall is used („hide”) - thus the parked pack of panels will not disturb general view of the room.

As for the structure, a movable wall panel includes aluminium profiles, various sound insulation materials and painted, stained or laminated boards, offering broad decorative range. Thickness of the panels can be 98-120 mm, depending on sound insulation requirements.

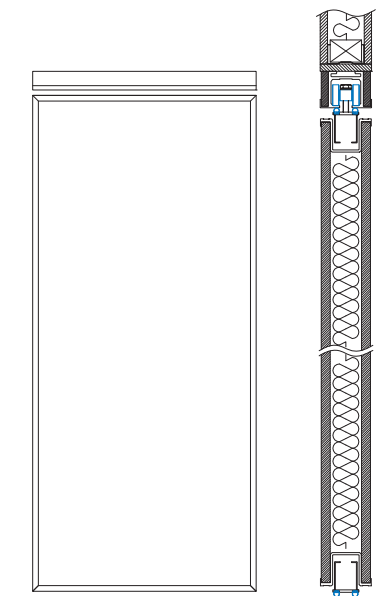

Thickness of a panel: 98-120 mm

Recommended width of a panel: 800-1300 mm

Height of a panel: max 6000 mm

Wall weight: 25-63 kg/m², depending on sound insulation

Sound resistance (Rw): 42-55 dB

Finish: painted according to paint catalogues (RAL/NCS), veneer, stain, varnish, laminated, special solutions (school blackboard, magnetic board, cork etc)



WITH WOODEN FRAME

ALUMINIUM

FULL GLASS

MOVABLE WALLS

Folding wall

Light folding wall

Movable wall

Full glass movable
and folding wall

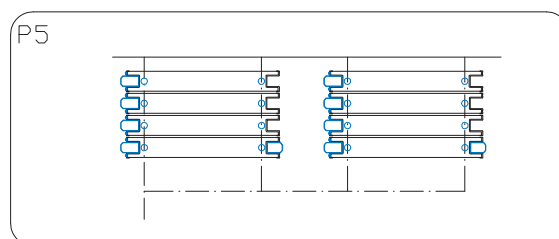
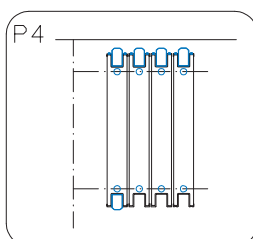
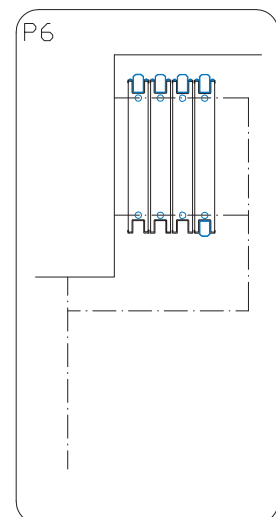
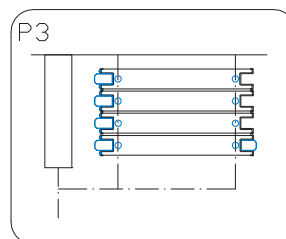
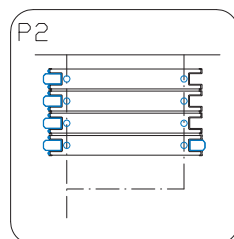
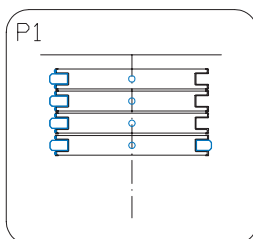
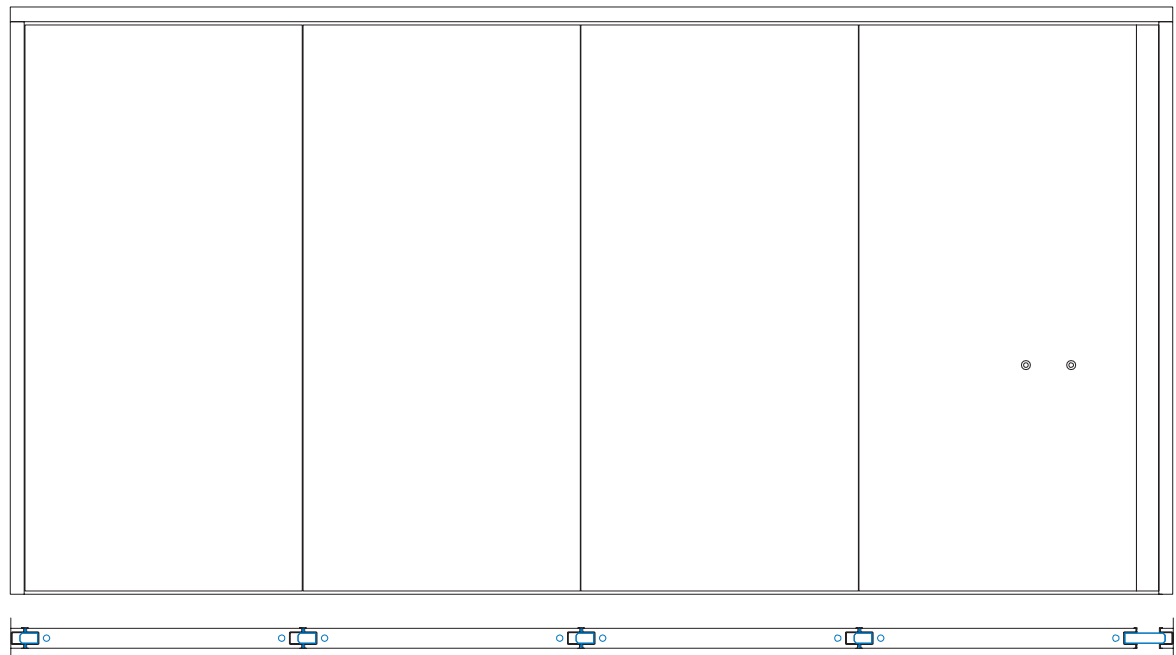

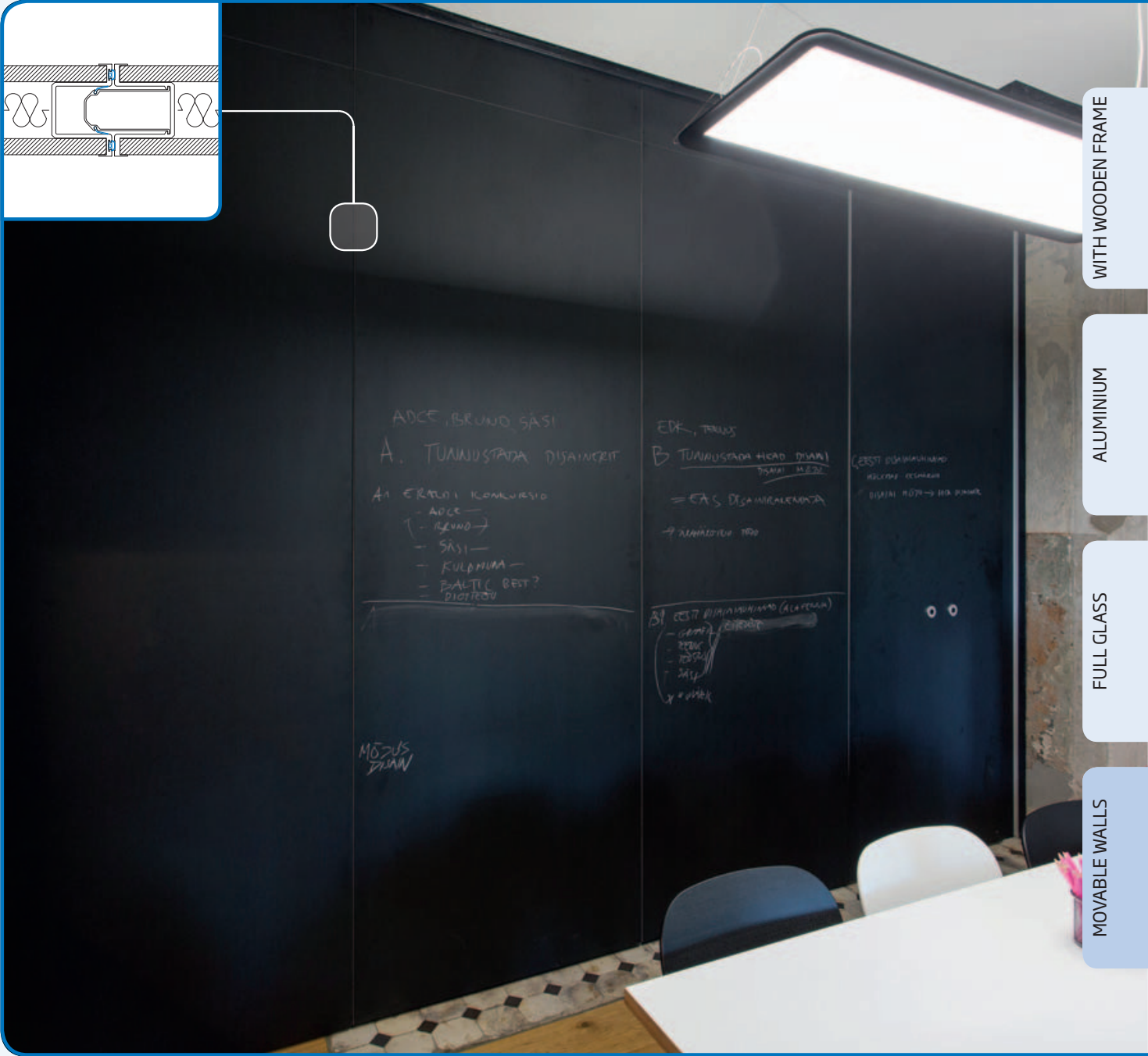
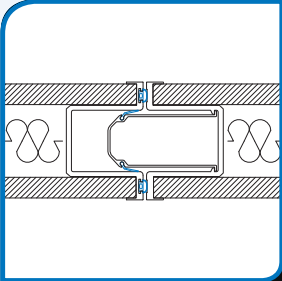

ADCE, BRUND, SÄSI

A. TUUNUSTADA DISAINIT

A1 ERALD I KOLLEKTSIO

- ADCE
- BRUND
- SÄSI
- KULPUNA
- PÄÄTLE BEST?
- PLOTTEU

MÖÖS
DIAW

EDK, TONUS

B. TUUNUSTADA HICAD DIAW

= EAS DISAINALEMATA

→ KAHNISTEN 1000

B1 EESTI DISAINAMINE (ALAPPAH)

- GRAP / PLOTTE
- PLOT
- PLOT
- PLOT
- PLOT

EESTI DISAINAMINE
HICAD DIAW
DISAIN. PLOT → HIC DIAW

WITH WOODEN FRAME

ALUMINIUM

FULL GLASS

MOVABLE WALLS

Folding wall

Light folding wall

Movable wall

Full glass movable
and folding wall

Full glass movable and folding wall (TKS and TKV)

Easy to relocate glass panels are an ideal solution for partition of rooms, where mainly openness and transparency is required. Panels can be adapted to various design and space needs, either straight, under an angle or elegantly curved. Panels move smoothly and silently even in case of large dimensions.

Transfer wall includes glass panels and upper and lower horizontal aluminium profile fixed to them. Panels are fixed to the ceiling with upper rail. Each panel of a transfer wall is latched to the floor in closed position. The last panel of a wall can be used as fixed door. This panel is equipped with floor lock for safety reasons.

Folding wall includes horizontal aluminium profiles mutually joined with hinges, while vertical profiles are lacking. Such folding wall moves smoothly and silently on the rail fixed to the ceiling. Panels may be centred in relation to the rail (P1 & P3) or located eccentrically on one side of the profile (P2 & P4). In case of eccentric location, U-shaped guide rail is installed to the floor („doorsill“), to prevent shifting of panels.

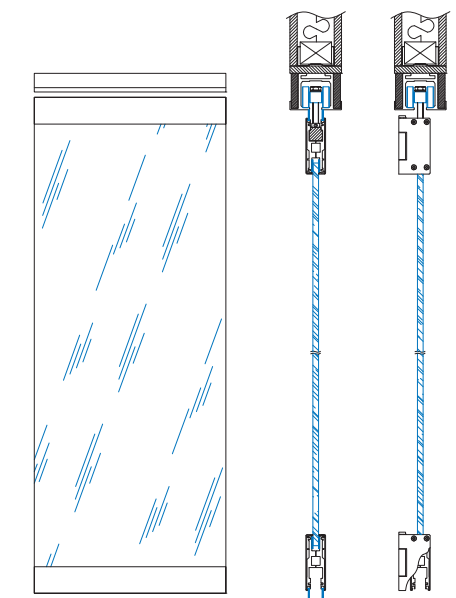

Dimensions of the profile (thickness × height): 35 × 100 mm

Recommended width of a panel: 400–1100 mm (standard 900 mm)

Recommended wall height: up to 3300 mm

Wall weight: 30–35 kg/m², depending on glass type

Glass of standard solution: 8–12 mm / 55. 2 / 66. 2 laminated

Sound resistance (R_w): – / 34 dB

Finish of profiles: powder paint, naturally anodised or stainless steel

Lock: Assa, Abloy, Roca, Dorma

Handle: flush or regular handle

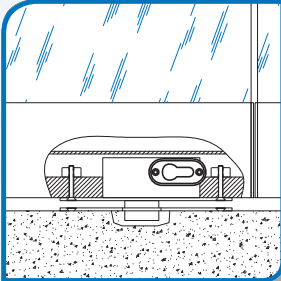

WITH WOODEN FRAME

ALUMINIUM

FULL GLASS

MOVABLE WALLS

Folding wall

Light folding wall

Movable wall

Full glass movable
and folding wall

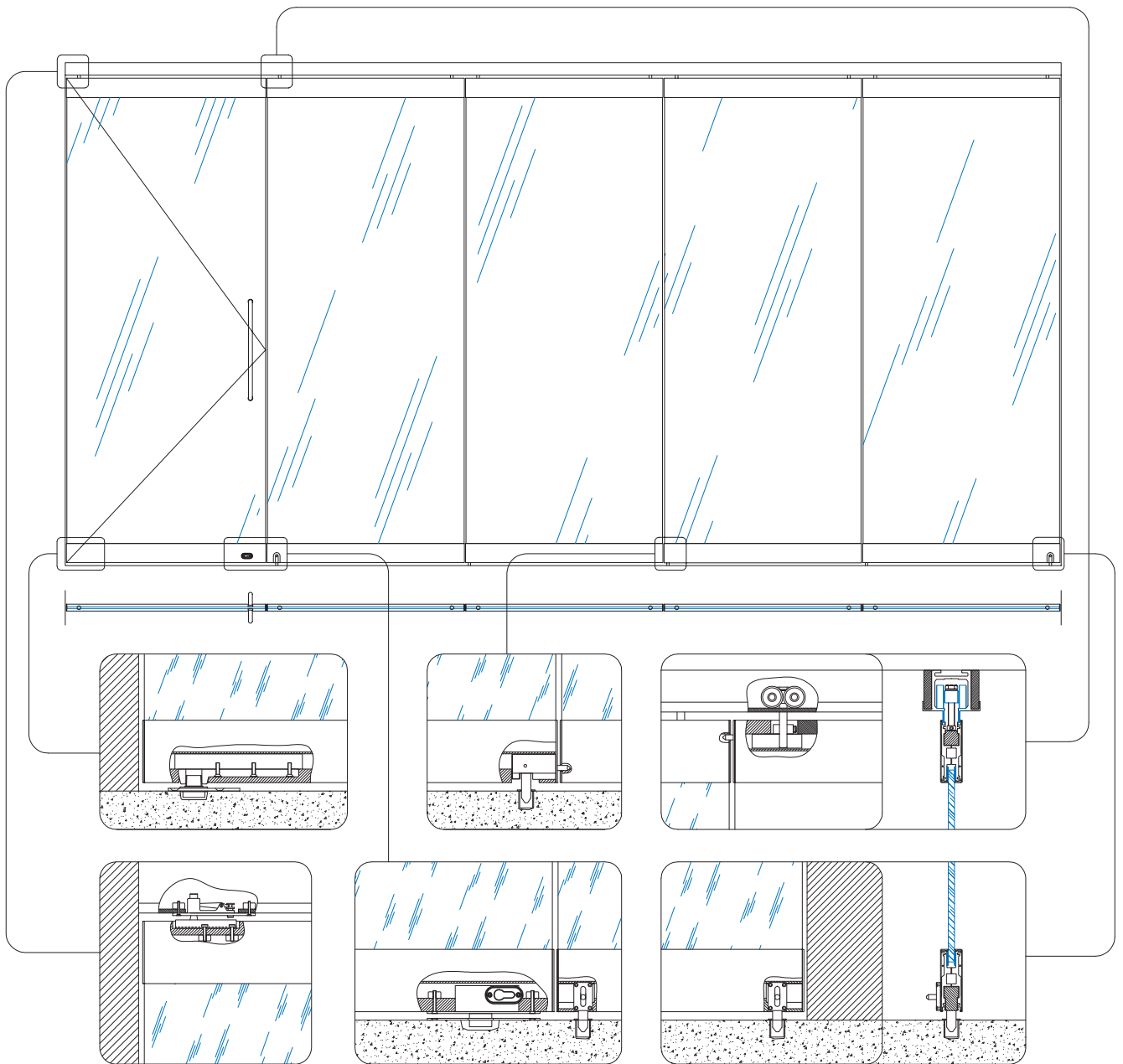

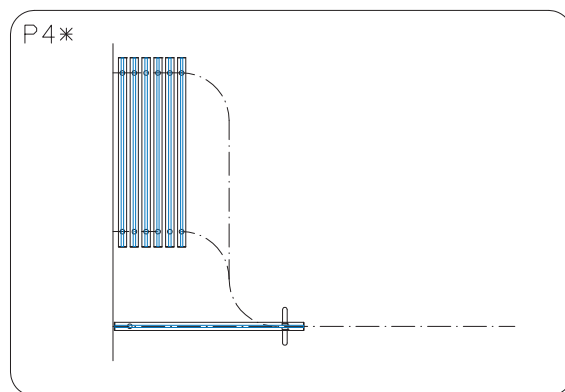
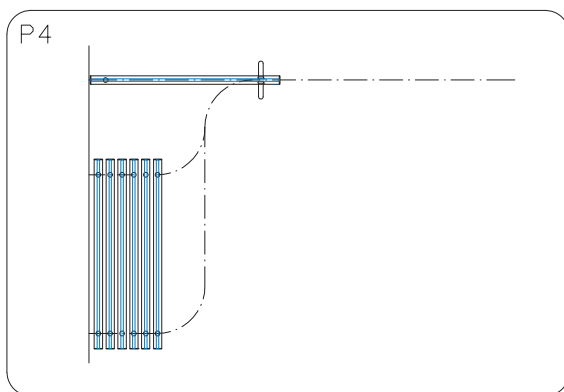
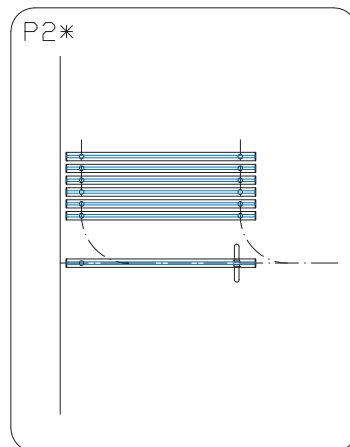
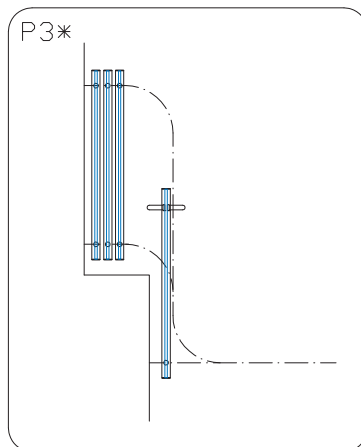
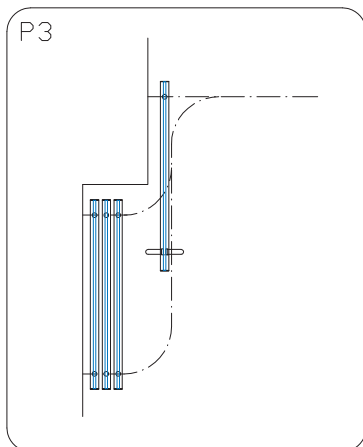
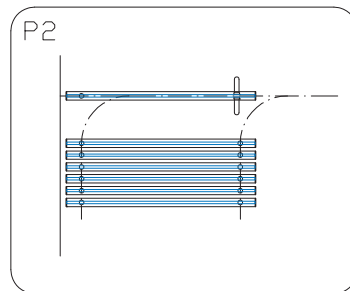
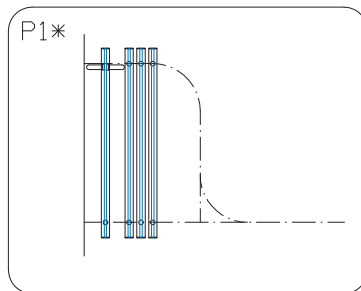
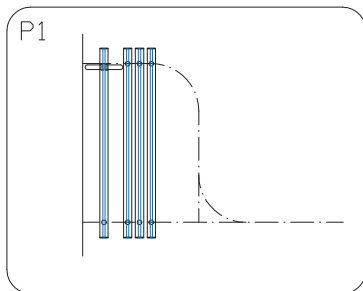

WITH WOODEN FRAME

ALUMINIUM

FULL GLASS

MOVABLE WALLS

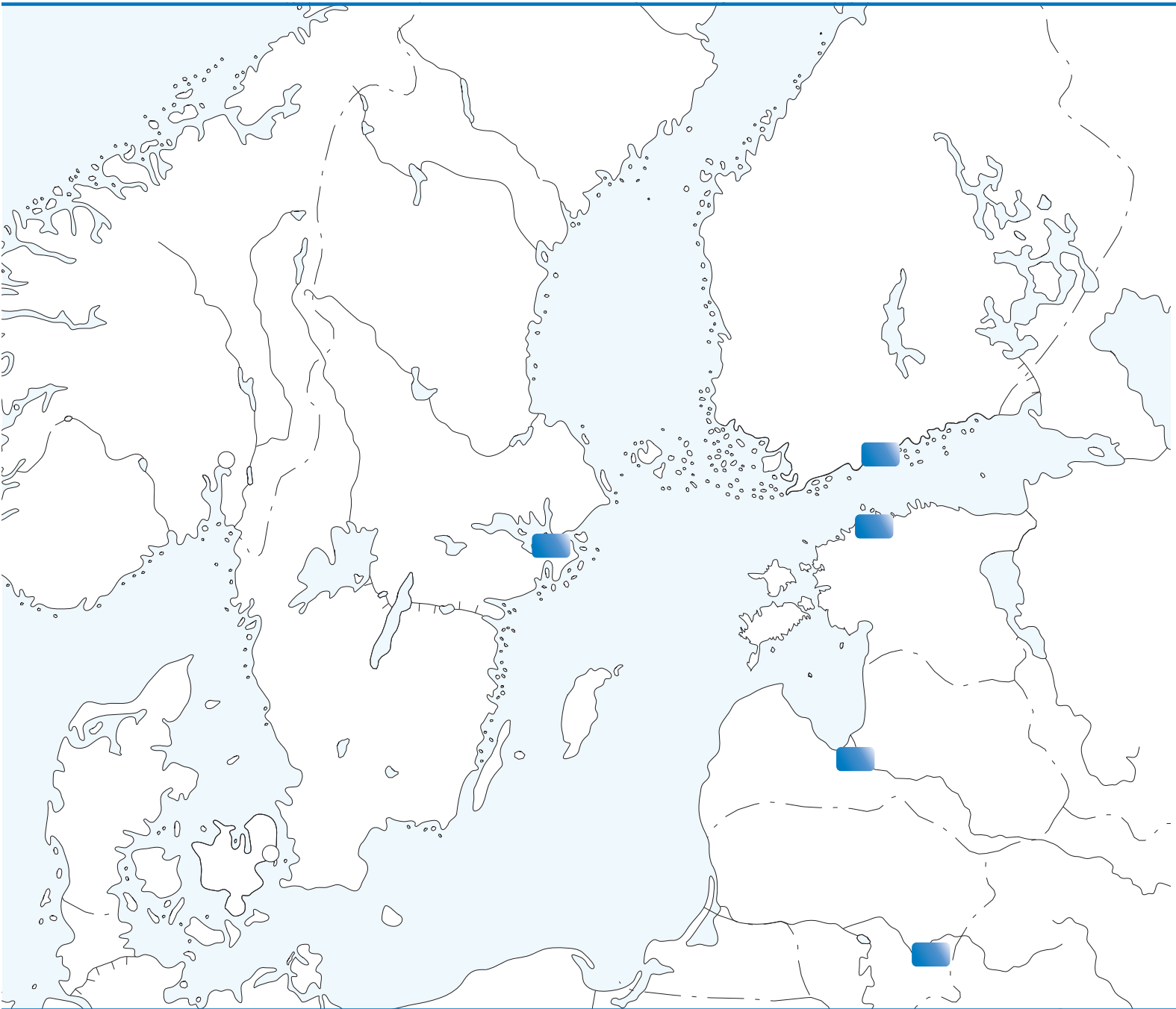



Areas of activity of Glassway OÜ are design, manufacturing and installation of aluminium, plywood and MDF profile glass separation wall systems. Glass separation walls provide to a customer flexible options for designing their work environment and create a possibility to change rapidly the size and location of rooms. Glass walls provide spaciousness and light, making the spaces more elegant.

Our professional team has long-term experience in design and installation of partition walls. We find solution even for the most complicated plan! We have experience also in realisation of major international projects. Teamwork, commitment and outstanding experience ensure success of a project and fulfilment of the needs of even the most demanding customer!

**Latvia,
Lithuania, EU**

Glassway OÜ

Kotkapoja 2a
10133 Tallinn
+372 5559 9999
info@glassway.ee
www.glassway.ee

Estonia

Glassway OÜ

Kotkapoja 2a
10133 Tallinn
+372 5559 9999
info@glassway.ee
www.glassway.ee

Finland

Inneco OY

Kauppalankatu 2
05800 Hyvinkää
+358 (0) 400 871 867
info@glassway.fi
www.glassway.fi

Sweden

Glassway AB

Älgvägen 12
131 50 Saltsjö-Duvnäs
+46 (0) 707 444 222
info@glassway.se
www.glassway.se

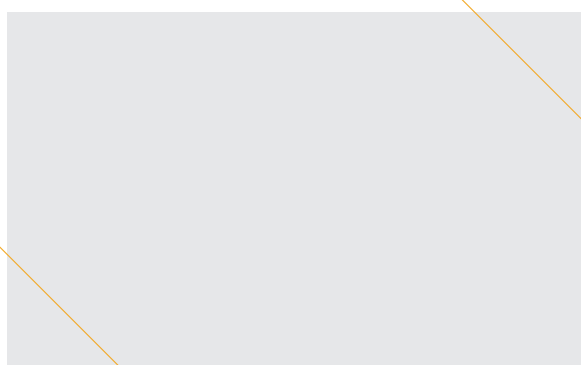

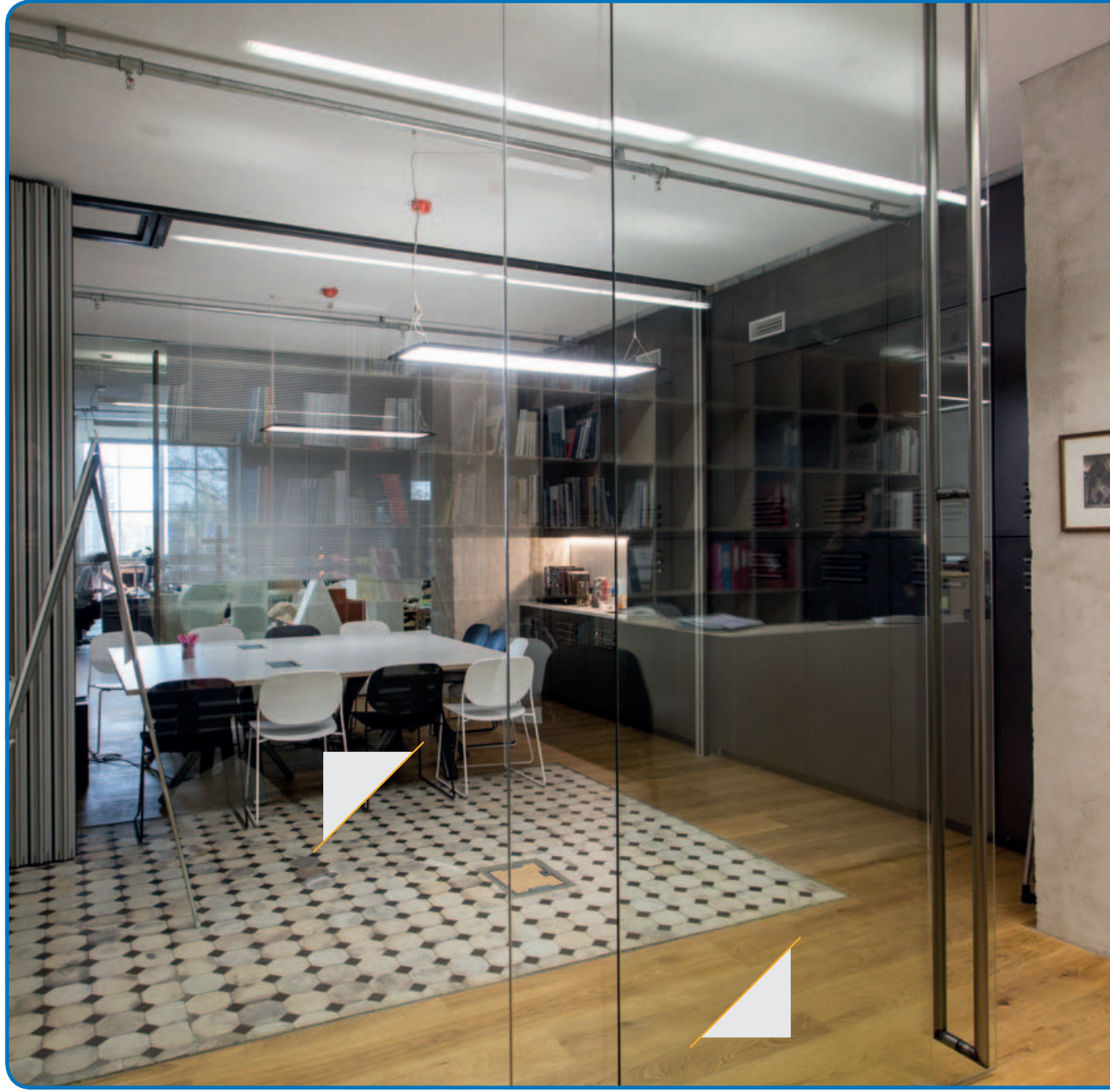

Glassway